

WANBOROUGH VILLAGE & COUNTRY SHOW 2024

SATURDAY 17TH AUGUST

Church Meadow, Upper Wanborough



Adults **£7** | Concessions **£4** | Children (5+) **£3** | Children under 5 **FREE**



**WANBOROUGH
SHOW SOCIETY**

"For Community & Local Heritage"
www.wanboroughshow.org

Est.1986

Chappells

ESTATE AGENTS

Sales • Lettings • New Homes • Mortgages



*Town & Village specialists -
experience others envy*

*Contact us now to arrange
your free valuation...*



LETTINGS

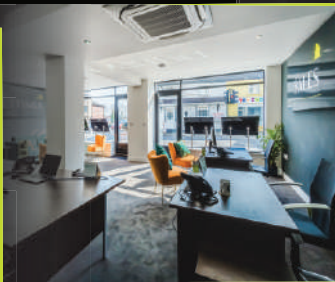

📞 01793 618080

✉️ sales@chappells.uk.com ✉️ lettings@chappells.uk.com



Our chairman's annual address

Third year in the post that I volunteered to cover on a temporary basis!! This will be my 25th Year involved with the Show Committee having previously covered providing teas and sandwiches for all the helpers on the day, starting and running the Carnival as a 1 off in 1999 with Linda and Kathy, (It ran for 17 years), Evening event in the large marquee and running the Tea Tent during the day, I was involved in many years as a supporter prior to that. I would really like to find a replacement for the Chair within the next 2 years. I'm getting too old for all this malarky, the show needs new ideas, and new blood. Are you that person? Contact me with a view to becoming Vice chair for the next couple of years.... Think you might? Call me! Or see me in the bar at the end of the Show.

Last years show went very well apart from some issues behind stage but we had the acts, and the weather, and apart from the entry fee, you can spend the whole day on the show ground and not spend any money if you bring your own picnic. We even cover a couple of free events for the children and teens. Our main cash revenue is money made on the gate although we are so very grateful for the sponsor's listed further on in the programme.

A very big welcome to our new neighbours at Redlands Grove, we hope to see you on the day to see what a great show is put on by a happy bunch of volunteers, without who this event would not happen.

So please join us up on Church Meadow, enjoy the afternoon's attractions, enjoy the Vehicle Display and the Horticultural Tent, please remember it is so much more fun if you enter your Fruitcake, Veg and or Prized flowers, it all adds to the fun when you pick up that valued Prize Card.

See you on the day, you will find me in the Horticultural Tent.

Cheers

Sue Ripley

Chair



@wanbshow



@Wanborough_show

Cover Competition - Best of Year



Overall Winner: Haadiya Zaheer



Reception Winner: Charlie Kent



Year 1 Winner: Benjamin Green



Year 2 Winner: Amelie Mannion

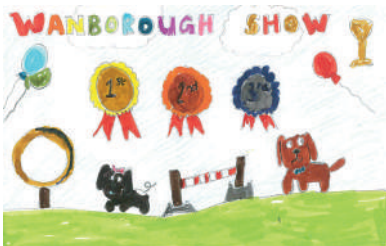

Year 3 Winner: Thomas Walley



Year 4 Winner: Ruby Bizley



Year 5 Winner: Evie Bell



Year 6 Winner: Daisy Walley

Contents Page



- | | | |
|--------------------------------|----------------------------------|---------------------------------|
| 8 Flower & Produce Show | 29 Show Day Entertainment | 38 Children's Classes |
| 23 F & P Entry Form | 30 Vehicle Display | 47 Children's Entry Form |
| 25 Schedule of Events | 32 Wanborough Show Raffle | 49 Companion Dog Show |
| 26 Map of Showground | 37 Public Notices | |

Join us for a fun family day out

Dog Show | The Sweeper | Craft Tents | Flower & Produce Show | Children's Show Raffle | Bouncy Castle | Vehicle Display | Beer Tent | Climbing Wall + much more

Adults **£7** | Concessions **£4** | Children (5+) **£3** | Children under 5 **FREE**

Cars **£2** | Family Ticket **£20** (2 Adults & 2 Children)

Cash & card payments accepted on the gates

Main Arena Sponsored by



Vehicle Display Sponsor



Main Arena Sponsor - Lawson Group



Flower & Produce Show Sponsor



Climbing Wall Sponsor



The Sweeper Sponsor

richard james

Village & Country

Children's Show Sponsor

**LES SMITH
HAULAGE LTD**

Delivered With Experience

Raffle Sponsor

Finance & Transparency

We thought you may like an idea of just how much it costs to put on the show. Please be aware that costs have increased to us this year, **by roughly 12%**.

Our constitution requires us to keep enough money to pay for following years show in the bank. So fingers crossed we will have a good day and the sunshines for us all. We are so grateful to the support from our advertisers and sponsors.

Marquees – £3,519

Loos – £1,310

Entertainment – £5,000

Insurance – £388.77

Programmes (Summer Show) and Website (Hosting) – £1,097

Ancillary costs too many little ones to mention, however it costs approx £11k to put on.

Want to see your business here next year?

Reach out to our Sponsorship team to enquire.



SAVE 10%

10% off with this advert for the next 8 weeks (01/07/24 – 31/08/24) on production of advert with Amy, Gill or Tina.

7 High Street Chiseldon Wilts SN4 0NQ | 01793 740147



Cameo Hair Salon is a well established rural salon of 39 years experience. Offering a fair pricing policy that rewards us with a diverse range of clients. Also providing NHS wig Patients and has an inhouse Trichology Clinic. Current Award winners of 2024 Wiltshire Life Buisness of the Year.

cameo-hair.co.uk



Vinny Warner
Bricklaying Contractors
07787292519



Flower & Produce Show

See page 23 for entry form

FREE TO ENTER

Sponsored by



Flower & Produce Show Rules

1. The Judges decision shall be final.
2. Only one named exhibitor per entry.
3. One entry only per person per class.
4. All classes are open to all but Special Awards are restricted to the residents within the parishes of Wanborough, Hinton Parva, Liddington and Bishopstone, (with the exception of a special award for the highest points for a non-resident).
5. The Exhibitor must have grown the produce, with the exception of the Floral Art classes.
- 6. Entries will close at 22.00 on Thursday 15th August 2024.
No entries will be taken after that time**
7. All exhibits to be staged between 8:30 and 10:30 on show day, after which time the marquee will be closed for judging until 14:00.
8. Entries into Flower and Produce tent will be FREE this year.
9. The Show Society shall not be responsible for loss or damage to exhibits, vases or containers.
10. Any protest should be made to the Flower and Produce Secretary before 14:30.
11. No Prize Money.

Unless otherwise stated in the schedule, the rules contained in the Horticultural Show Handbook 2016 shall apply.

Presentation of Main Awards will be in the Horticultural Tent, around 16:00

Please would prize winners be available at this time. After 16:30 exhibits may be removed.

Exhibits remaining at 17:00 will be auctioned in the Beer Tent. The Committee extends its grateful thanks to those exhibitors who leave their produce for the auction.

Post entry forms to:

Sue Ripley - 1 Palmers Way, Wanborough SN4 0BE

Email entries: sueripley58@hotmail.com (no entry fees to pay)

Greatfield Nurseries & Garden Centre

A traditional garden centre focused on horticulture

Near Royal Wootton Bassett (in Greatfield on the road to Purton) SN4 8EQ

Tel: 01793 770381 www.greatfieldgardencentre.co.uk

OPEN: Monday - Saturday 8am-5:30pm and Sunday 10:30am-4:30pm



The best well stocked & competitively priced garden centre in the area. Come and view our great range of products.



- Ample car parking
- Friendly, knowledgeable advice
- Delivery service available
- Monthly special offers.



SPECIAL OFFER

Growise Multi-purpose Compost
3 bags for only £9.99!

- Aggregates
- Bird Feed
- Timber Products
- Greenhouses
- Sheds
- Slabs
- Garden Ornaments
- Pots
- Cat & Dog range
- Turf
- Railway Sleepers
- Soil, Bark & Grow Bags
- Timber Fencing
- Arbours & Arches
- Water Features
- Garden Furniture
- Seeds
- Garden Tools
- Fertilisers

Please don't forget to mention where you saw this advert!

Special Awards

**Loveday and
Loveday Perpetual
Challenge Cup**
*Highest Points in
Sections A, B & C*

**Jack Newson
Perpetual
Challenge Cup**
*Second Highest in
Sections A, B & C*

**Greatfield
Nurseries Cup**
*Best exhibit in
sections A,B & C*

**N. J. Dowden
Perpetual
Challenge Cup**
*Best Vegetable
in Show*

**Wanborough Herb
Nursery Perpetual
Challenge Cup**
*Best Herb Collection
in Show*

**Ashley Roberts
Perpetual
Challenge Cup**
Best Flower in Show

**F. R. Payne Memorial
Challenge Cup**
*Best Roses or
Sweet Peas*

**C. J. Hymers
Perpetual
Challenge Cup**
Best Dahlia Exhibit

**Roy Kent Memorial
Challenge Plate**
*Highest Points
in Section C*

Jean Kent Plate
*Best Vase of
Perennial Flowers*

**J. R. Bell Perpetual
Challenge Cup**
*Best Exhibit from
a New Exhibitor*

**Trish Emms Perpetual
Challenge Plate**
*Best Exhibit in
Cookery*

**St. Andrews Flower
Club Trophy**
*Best Exhibit in
Floral Art*

**Wanborough
Show Cookery
Challenge Shield**
*Highest Points
in Cookery*

**Church Meadow
Perpetual
Challenge Trophy**
*Second Highest
Points in Cookery*

**Wanborough Cake
Challenge Trophy**
*Best Fruit Cake
in Cookery*

**Jubilee Perpetual
Challenge Trophy**
*Best Exhibit in
Arts and Crafts –
Classes 86 – 98*



LET'S GET A MOVE ON...

Sell your Home

for just **1%**
+VAT

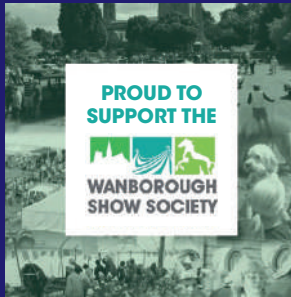

Let your Property

for just **10%**
+VAT

PRIMARY
HOMES & LETTINGS

CONTACT US TODAY ON 01793 641 641
TO ARRANGE A **FREE** VALUATION

info@primaryhomesandlettings.co.uk | primaryhomesandlettings.co.uk
101 Commercial Road, Swindon, Wiltshire, SN1 5PL

Your local family run business

Exhibitors' Notes

3 Easy Steps On How To Enter

1. Plan

Study the programme schedule of classes and decide which classes you would like to enter.

Complete the Entry Form on page 23.

2. Enter

Send, drop off, or email the entry form to the addresses on the form before the closing time on 15th August.

Don't forget that you don't have to be an adult to enter the Flower and Produce Show but you do need to use the Flower and Produce Entry Form.

3. Stage

Bring along your exhibit(s) to the marquee between 8:30 and 10:30 on Show Day allowing yourself time to stage your produce or exhibit(s).

On arrival at the marquee register your name with the 'Meet and Greet' Team who will give you your entry no. to display on your exhibit(s).

Stewards will be on hand to help and give advice if needed.

Return later, after judging is completed, to enjoy the Show and see whether you have a prize card beside your exhibit(s).

Please collect your exhibits by 16:45, as produce remaining is then entered into the Produce Auction in the Bar.



@wanbshow



@Wanborough_show

Section A – Vegetables

Judges of section: Jane & Matthew

NB: Please Note ONE entry only per person per class

Class	Quantities
1. Runner Beans	9
2. Longest Runner Bean	1
3. Curliest Bean	1
4. Basket or Trug of mixed Vegetables	Any number or variety
5. Beet (Round)	3
6. Cabbage, (Round or Pointed, incl. Red)	1
7. Carrots, (Long or Intermediate – Tops removed to approx 7cm)	3
8. Courgettes	3
9. Cucumbers, (Frame or Ridge)	2
10. French Beans	6
11. Garlic	2
12. Onions, (Tops removed, max 250g each)	5
13. Onions, (Tops removed over 250g each)	3
14. Peppers, (Chilli)	3
15. Peppers, (Sweet)	2
16. Potatoes, (Coloured)	5
17. Potatoes, (White)	5
18. Heaviest Potato	1
19. Rhubarb	3
20. Shallots, (Giant)	9
21. Shallots, (Pickling)	9
22. Squash/Pumpkin	1
23. Sweetcorn	2
24. Tomatoes	6
25. Tomatoes (Cherry or Patio)	6
26. Heaviest Marrow	1
27. Any other Vegetable not mentioned above	3
28. A Vegetable to make you smile, may be decorated for effect	1
29. Collection of Herbs, bunched and labelled	5 kinds

Hints and Tips for Vegetable showing

- *Harvest your entries as close to show day as possible for maximum freshness, except for garlic, onions or shallots; alliums need time for the skins to dry. Cucumbers do gain extra points if the flower is still attached.*
- There's lots of advice online about 'staging', or presenting your vegetables, but don't forget that we use the RHS Horticultural Show Handbook. Check with Sue Ripley if you don't have a copy.

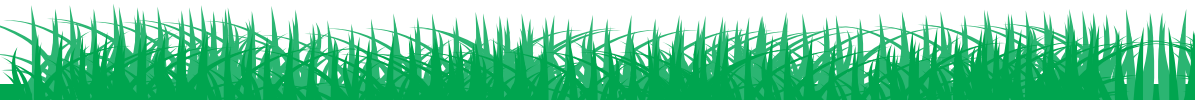

Section B – Fruit

Judges of section: Jane & Matthew

Class

- 30. Apples - (Cooking)
- 31. Apples - (Dessert)
- 32. Soft Fruit
- 33. Any other Fruit

Quantities

6
6
Approx. 250g
Dish of any kind staged for effect

Hints and Tips for Fruit showing

- Do not remove the bloom, and don't polish fruit for exhibition
- Ideally display fruit with stalks still attached.

LES SMITH HAULAGE LTD

Delivered With Experience

For all your storage, haulage and distribution needs throughout mainland UK, we are happy to undertake short or long term contracts and we are always interested in full return loads to the Swindon Area.

45+ Years Experience
90% of our fleet are London compatible
Same, Next Day & Economical Delivery Options

www.lesmithhaulage.com | 01793 525789 | tony@lesmithhaulage.com



Section C – Flowers

Judge of section: Mr Peter Biggs

Class:	No. of Stems
34. Annuals, 'jewels of the garden'; bright and beautiful colours. Grown from seed within the last 12 months	3 cultivars, 1 vase of 9 stems
35. Marigolds, African	6 blooms
36. Marigolds, French	6 blooms
37. Dahlias, (Cactus/semi cactus)	1 cultivar, 3 blooms
38. Dahlias, (Pom-pom) Max size 50mm	1 cultivar, 3 blooms
39. Dahlias, Any other	1 cultivar, 3 blooms
40. Gladioli, (Large Flowered)	1 cultivar, 3 blooms
41. Hydrangea (may have 2 blooms per stem)	3 stems
42. Agapanthus	3
43. Hardy Herbaceous Perennials in bloom	3 cultivars, 1 vase of 10 stems
44. Phlox	1 cultivar, 3 blooms
45. Alstroemeria	5 stems
46. Rose Hybrid T	1 Bloom
47. Roses, any cluster flower type	3 stems from 1 cultivar
48. Miniature Rose	1 cultivar, 3 blooms
49. Best flower in the Garden this Morning	1
50. Sweet Peas	12

Hints and Tips from the judge for showing Flowers

- Please read the schedule carefully, and display the correct number of stems/blooms.
- Generally, a 'Herbaceous Perennial' flowers every year, has fresh green stems, which die back to ground level in the winter. A Shrub grows every year, but has woody stems which don't die back.
- An Annual is a plant that grows from seed for a single year.

Section C – Pot Plants

Class:	Quantities
51. Cacti or Succulent (Max. pot size 26cm)	1
52. Foliage Pot Plant	1
53. Fuchsia - Single or double (Max. pot size 26cm)	1
54. Geranium or Pelargonium - Any cultivar (Max. pot size 26cm)	1
55. Flowering Pot Plant	1

Section C - 'Special' Categories

Judges: Mr Steve Ramsay

56. Hanging Basket or Planter (the container should not be bigger than 75 cms square or diameter), or Window Box (not more than 2 metres long), holding a minimum of 3 cultivars or species of plant. This will be judged in situ Thursday 15th. No need to bring up to the show ground.
57. Tallest Sunflower. Grow a giant sunflower from seed and we will come and measure it on the Thursday 15th before the show.

CAMTEC INSTALLATIONS
24 HR EMERGENCY ELECTRICIANS IN SWINDON
ELECTRICAL SERVICES

CONTACT US:
01793 495969

Domestic & Commercial All work Guaranteed

www.camtecinstallations.com
Email: info@camtecinstallations.com

APPROVED CONTRACTOR UNAS Electrical Safety Register NICEIC

Section D – Floral Art

Judge of section: Jean Nash

Class:

58. Enchanted – A Petite Arrangement – 10cm high x 10cm deep
59. Foliage Exhibit in a Basket – 45cm in any direction
60. Handtied Winners Bouquet – Paris Olympics
61. Table Decoration suitable for centre piece on a table - Strawberries and Cream – 40cm in any direction
62. Reach for the Sky – 36cm deep x 36cm wide x 60cm high – Colours to be predominantly Blue
63. Little Gems – An exhibit on a circular base, 25cm x 25cm

Hints and Tips from the floral art judge

- An 'exhibit' is composed of natural plant material with or without accessories, contained within a space as specified in the show schedule.
- Backgrounds, bases, containers, drapes, exhibit titles and mechanics may always be included in an exhibit unless otherwise stated.
- More than one placement may always be included unless otherwise stated.
- In all exhibits natural plant material must predominate.
- Artificial plant material, including artificial fruit is not allowed.
- Natural plant material is either growing fresh, dried or preserved, i.e. flowers and foliage.
- Flowers do not need to have been grown by the exhibitor.
- Take care to ensure display is within the dimensions stated.

Section E – Cookery

Judges of section:

Savoury & Sweet Dishes: Toby Ridler

Jam & Marmalade: Jenny Yallop

Wines, Beers & Liqueurs: Dave Lockwood

Class	Quantities
64. Bread – Specialist Loaf or Rolls	1 or 6
65. Sausage rolls (meat or plant based)	6
66. Pork Pie	1
67. Quiche – no larger than 24cm	1
68. Fruit Scones	6
69. Scotch Egg	2
70. Chutney or Piccalilli	1 jar
71. Pickled or preserved vegetables or fruit	1 jar
72. Jam or jelly (made in last 12 months)	1 jar
73. Citrus curd	1 jar
74. Marmalade (any citrus, made in last 12 months)	1 jar
75. Home-made wine, cordial, beer, cider or perry	1 bottle
76. Fruit liqueurs e.g. Sloe/Rhubarb gin(made with vodka, gin or brandy of 20% ABV)	1 bottle
77. Fruit cake – no larger than 23cm diameter. (See Special Awards)	1
78. Victoria Sandwich – 3 egg mixture. Jam only for filling	1
79. Fruit Pie (double crust), no larger than 23cm diameter	1
80. Shortbread Fingers	6
81. Flapjacks	6
82. The Great Wanborough Bake Off – Technical – Cinnamon Plait (Recipe on Page 20)	1
83. Pastel De Nata	4
84. Chocolate Eclairs with Creme Pat	6
85. Gluten Free Brownies	6

Hints and Tips from the cookery judges

- Flavour, presentation, consistency and texture are the criteria used for judging.
- It is really helpful to add a descriptive label.
- We can't control the temperature in the Flower and Produce Tent. Please be aware of this when serving food which has been in the tent for some time. Be particularly wary of using fresh cream for decoration.

Recipe

Class 82: Cinnamon Plait

Ingredients:

- 1 quantity bread dough (see notes)
- 80g light brown sugar
- 1 tbsp ground cinnamon
- 125g salted butter, well softened
- 80g raisins
- Flour for dusting

Method

- 1) Make bread dough as in notes – roll out into a square about 1cm thick. Heat oven to 180°C/160°FAN/Gas 4
- 2) Combine sugar, cinnamon and butter in a small bowl, set aside about 25g of the mix, then spread the rest evenly over the dough, using a spatula or palette knife, scatter over the raisins. Starting with one of the long sides, roll up the dough into a log. Using a rolling pin, roll the log into a long rectangle about 8-10cm wide, roll gently – you don't want the dough to split, so the raisins poke out.
- 3) Using a sharp knife, cut the rectangle lengthways into 3 equal strips, leaving 2cm of dough intact at one end, so the strips stay together. Plait the strips along the length, then squeeze the ends together to seal.
- 4) Brush the reserved cinnamon butter over the top of the plait, then carefully lift onto a floured baking sheet, cover loosely with a clean tea towel, and leave to prove for 45 mins, or until the dough stays indented when gently pressed with your finger.
- 5) Bake for 30/35 mins until puffed and golden (cover with foil if it browns too quickly). Cool completely on a wire rack



Notes - Bread Dough

Ingredients:

- 7g Dried Yeast
- 1 tbsp Caster sugar
- 290ml Lukewarm milk
- 450g Strong Bread Flour plus extra for dusting
- 1tsp salt
- 1 Egg
- Oil for greasing.

Method

- 1) Dissolve the yeast and sugar in a little of the lukewarm milk, in a small bowl
- 2) Put the flour in a large mixing bowl with the salt. Pour in the yeast mixture, the rest of the milk plus the beaten egg. Stir with a round bladed knife until the dough begins to come together. Tip out onto a lightly floured work surface and knead for 10 minutes, or until the dough becomes smooth and elastic, and springs back when pressed lightly with your finger.
- 3) Put the dough into a lightly oiled bowl, cover with lightly oiled cling film and leave somewhere warm to rise for 1 hour
- 4) Tip the dough out onto a lightly floured work surface and knock back for a minute or two (gently knead to distribute the air.

Section F - Arts & Crafts

Judges of section: Sue Dent

Judge of Photography: Barbara Lockwood

Class

86. Art, any drawing or painting (oils, water colour, pastels, sketching crayons)
87. Art, any 3D work (ceramics, sculpture, woodcarving)
88. Needlework, (e.g. cross stitch, tapestry, embroidery, patchwork, quilting, appliqué)
89. Macrame plant holder, etc
90. Any crocheted or knitted item (jumper, hat, scarf, post box topper)
91. Beadwork or jewellery
92. Build and decorate a bird box - see page 22 for steps and inspiration
93. A Handmade sewn garment for child or adult
94. Handmade invitation to the Coronation of King Charles !!!
95. Handmade Wedding Invitation
96. Photography: Yellow
97. Photography: Humourous (with caption) – max size 30 x 30 cm
98. Photography: A Village Scene – max size 30 x 30 cm
99. Photography: An Unusual Perspective – max size 30 x 30 cm
100. Photography: Capturing the Season – max size 30 x 30 cm

Hints and Tips from the Arts & Craft judges

- Please add an explanation card to help the judge understand the skill involved and whether a kit has or has not been used.
- Ensure you cover any signatures on artwork or any other exhibits.
- Please let Sue Ripley know if you have a large piece of artwork to exhibit so we can allow plenty of space in the tent.



@wanbshow



@Wanborough_show

Instructions

Class 92: Build & Decorate a Bird Box

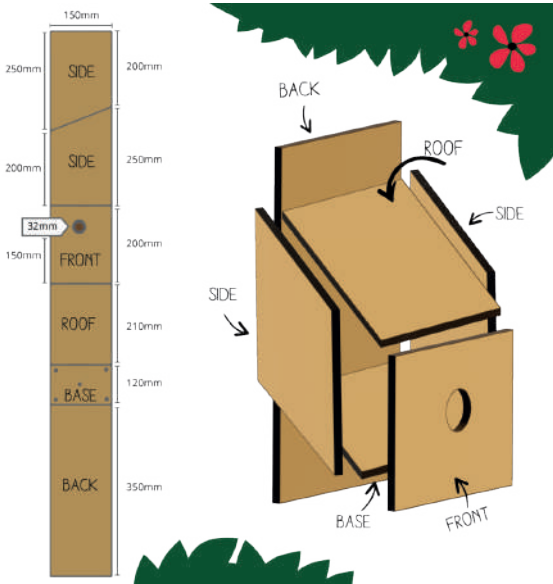

Scan QR Code for full video and instructions

How do you make a simple bird box?

You will need:

A plank of wood 15cm x 1.4m long x 1.5-1.8cm thick (ensure the wood is untreated)

Tape measure

Pencil

Saw

Screws or nails

Drill or hammer

Waterproof rubber or plastic sheet

A hole saw

A responsible adult to help with sharp objects and power tools

Step-by-step guide

1. Find the right bird-friendly spot for your box
2. Make sure you have the right wood
3. Measure and cut your wood according to the diagram
4. Nail all the pieces, except the roof, together
5. Attach the roof
6. Decorate your box
7. Put your box up.

Entry Form

Class No.	Exhibit Description

Name:

Address:

Contact number:

Please tick if eligible for the:
 New Exhibitor

Send entry forms to:
 Sue Ripley
 1 Palmers Way, Wanborough SN4 0BE

E-mail forms to:
 sueripley58@hotmail.com
 by 22.00 Thursday 15th August

Please provide postal address/postcode for email entries, for consideration of Special Awards.

NOTE: FREE ENTRY

Please do share any ideas and suggestions for new classes for next year by emailing:
 sueripley58@hotmail.com

If you would like to enter more classes, please continue on paper, or spreadsheet for email entries





Nationwide PROPERTY LETTINGS

Nationwide Property Lettings

Probably the most competitive fees of any experienced letting agent you will find (and we are from Wanborough).

In lettings, it's all about the detail
- and we get it right!

Call us on 01793 513130 or visit us at:
www.nationwidepropertylettings.com



Barrett Accounting and Tax Services



SELF ASSESSMENT TAX
RETURNS ● TAX ADVICE

COMPANY, SOLE TRADE AND
PARTNERSHIP ACCOUNTS
● BOOK-KEEPING

PAYE ● VAT

If you want service that gives value for money,
whilst being professional and efficient,
contact us on

01793 741250 or mail@barrett-ats.co.uk
for a free initial discussion

*Pleased to be supporting
The Wanborough Summer Show*

Schedule of Events

Showground opens to the public at Midday

This year our Entertainment Team have gone all out to bring you some world class entertainment, we believe this may be one of our best line ups.

Schedule of Events - Main Arena

- 12:05 – Vehicle Display
- 12:30 – Chippenham Morris Men
- 13:00 – Children’s Entertainment from Razamatazz
- 13:30 – K&H Falconry
- 14:00 – Steve Colley Trials Bike Show
- 14:30 – Visit from Dorset & Wiltshire Fire and Rescue (subject to emergency call out)
- 15:00 – Children’s and Produce Show Prize Giving
- 15:30 – Children’s Entertainment from Razamatazz
- 16:00 – K&H Falconry
- 16:30 – Steve Colley Trials Bike Show
- 17:00 – CLOSE

Schedule of Events - Dog Show

- 13.00 – Judging/Classes Start (see page 49 for classes)

Schedule of Events - Flower & Produce, Children’s Show

- 8:30 – 10:30 – Set up your Exhibitions
- 16:00 – Children’s and Produce Show Prize Giving
- 16:45 – Collection of Exhibits
- 17:00 – Produce Auction



@wanbshow



@Wanborough_show

Map of Showground

Key:

- Traders/Charities
- Food Outlets
- Commentary Tent
- First Aid
- Static Display
- Toilets

Showground safety:

The Commentary Tent at the side of the Main Arena is the main point of contact for any emergencies, lost children and lost property.

Beware of moving vehicles at the entrance, in the car parks and especially when the Vehicle Parade enters the Main Arena.

Please follow any direction given by one of our Stewards/Marshals, who will be clearly identifiable in a Wanborough Show Society hi-viz vest

Smoking is not permitted in ANY tent or marquee. Sand buckets are provided at each marquee entrance for safe disposal.

If a fire is discovered raise the alarm and dial 999 (SN4 0DA).

Please do not obstruct any exits or the marked Emergency Vehicle Safety routes.

Do not enter the roped off areas associated with exhibits. Keep children closely supervised.

First Aid is provided by **Diana and Sophie** in accordance with the Health and Safety event planning guidelines.

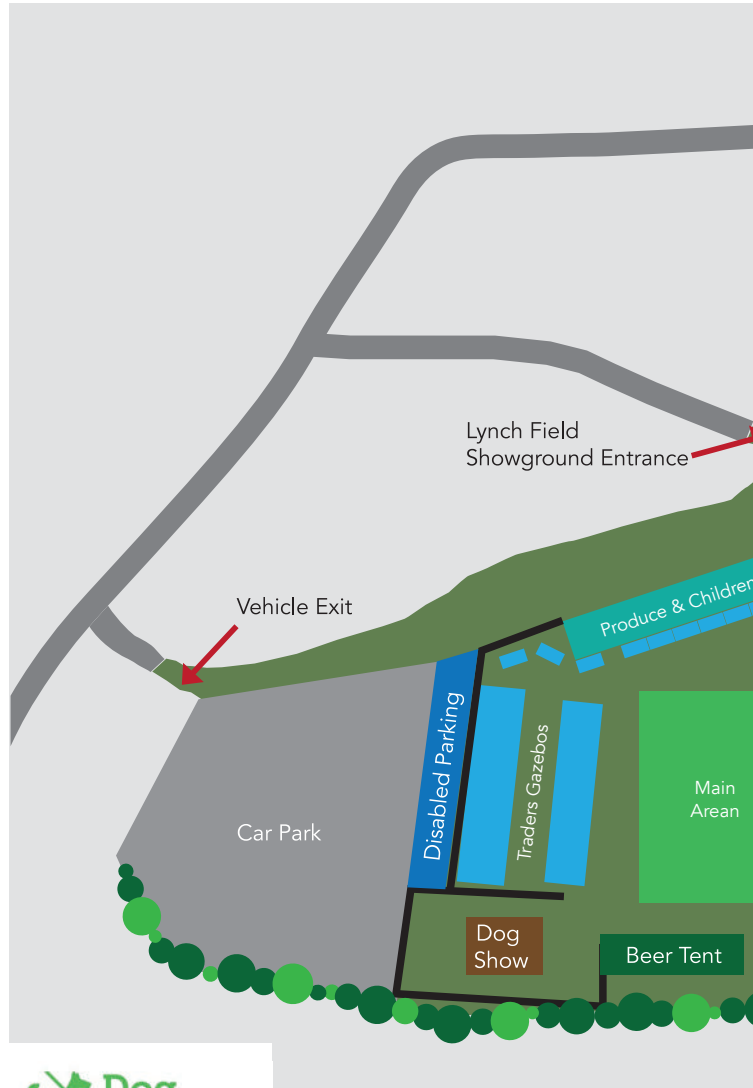

All dogs to be kept on a lead and under control at all times.

main arena sponsored by

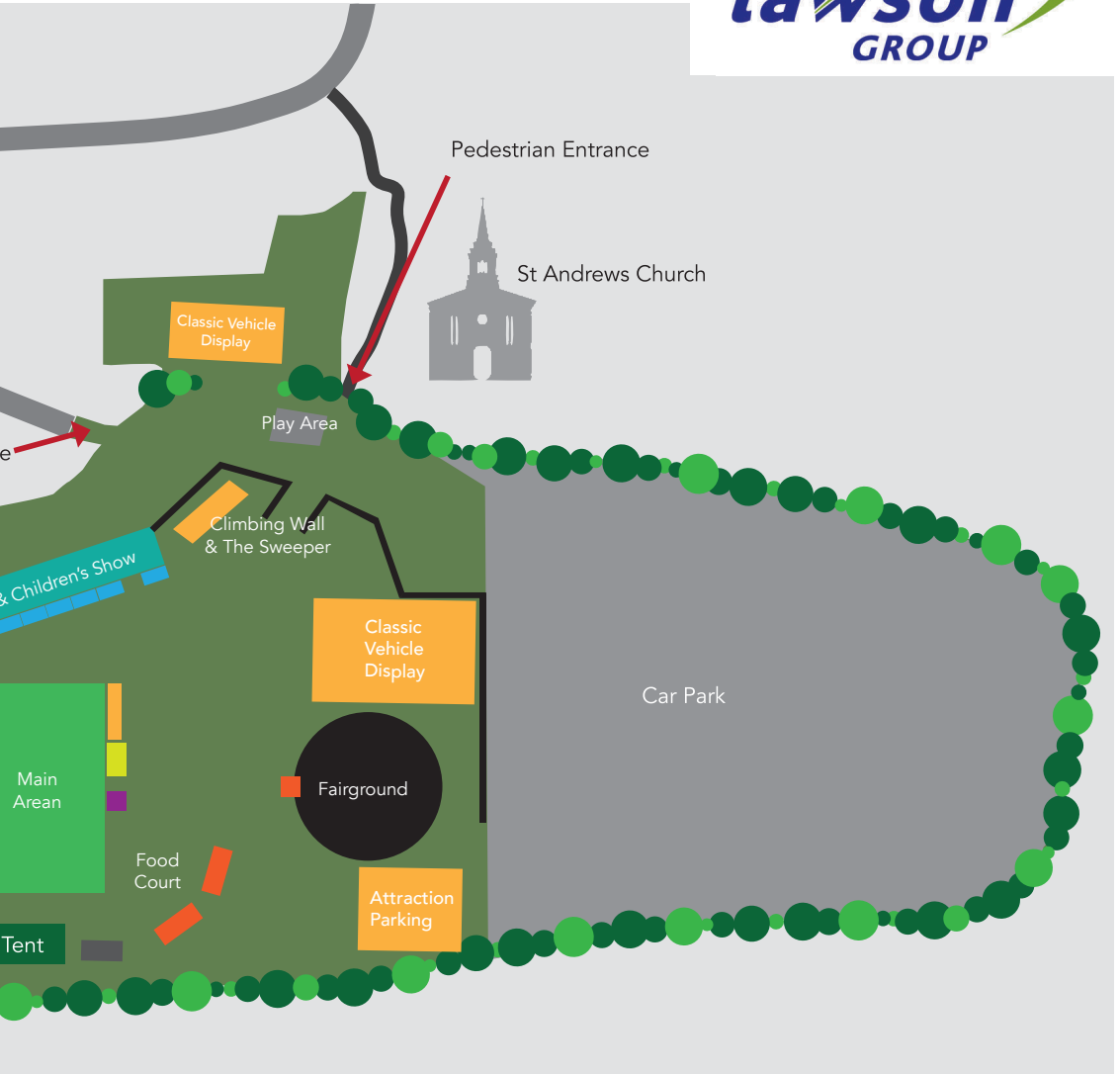

Layout is subject to change, correct at time of printing

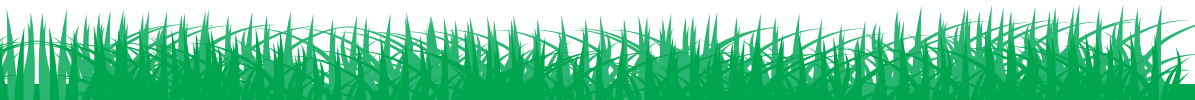



Steve Colley - Trials Rider

Steve Colley is one of the worlds' best trials riders. During his shows, you will see him perform amazing tricks and stunts including the world famous mono bike (Steve is the only trials rider in the world to perform this stunt) which has no front wheel or front brake.

You will be amazed by the jumps - including over people, drop off's, tricks/stunts and wheelies/stoppies into the crowd - therefore involving public participation.

Show Day Entertainment



Steve Colley - Trials Rider One of the worlds' best trials riders. During his shows, you will see him perform amazing tricks and stunts



K&H Falconry Watch one of the barn owls flying majestically through the air or catch an eagle owl flying from post to post. K & H Falconry have the most stunning team of falcons



Beer Tent / Gilmore & Jaz For your entertainment in the Bar. A guitar duo with their own style 1930's-1950's jazz and blues, with a Latino feel to create an atmosphere of a Greek Taverna or Tropical Island.



Vehicle Display This year there will be a vehicle display by the church. To add a bit more fun there will also be selection of vehicles on the show ground which will parade into the main arena.



Wildlife Display A 'hands on' approach with a variety of animals, including Snakes, Spiders, Scorpions, Insects, Meerkats and cute and cuddles.



Climbing Wall Back for 2024, **FREE attraction** for all. We will have a 4 man, 7 meter, climbing wall which will be staffed by 2 qualified guides throughout the day. Come try it out.



Wanborough Dog Show You can watch or take part. Entry is on the day only. Think you have the Prettiest Bitch or the Dog with the Most Appealing Eyes? Find out on the day.



The Sweeper Back for 2024, **FREE attraction** for all - You might have seen the Last Man Standing inflatable. The aim of this inflatable attraction is simple - just stand on the circle, and when the leg sweeper comes towards you, jump or duck in an attempt to evade it.

and much more!



Vehicle Display 2024

“Are there enough interesting vehicles in and around the parish of Wanborough to put on a display?”

It was a question which cropped up a few years ago, when we were thinking about new ideas for our village show. The answer of course was **“Yes”**.

So in 2013 we staged a new attraction which we have run successfully each year since – a vehicle display which has included some fabulous cars, old, new, customised, restored and original. We’ve been proud to have a pre-war tandem bicycle, some classic motor bikes and scooters. Military vehicles are a regular feature including some fearsome armoured vehicles and a jolly wartime Jeep.

Wanborough’s farming heritage has been well represented too with vehicles ranging from shepherd’s huts to steam engines. We’ve had earth movers and tractors – some old, some new, some very large and some quite small!

Last year we had a parade of vehicles in the arena representing vehicles from the 1920’s to modern day. We also had a display of a steam powered threshing



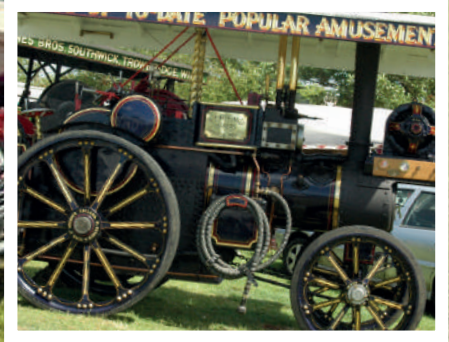

@wanbshow



@Wanborough_show

and beautifully restored and maintained commercial vehicles. This year we hope to do even better and whatever turns up on the day we feel sure it will give us plenty to enjoy share and chat about.

If you have an interesting vehicle and would like to take part please contact **John Boston 07774771551** or email **bostonj2@btconnect.com**

Sponsored by



Tickets
£1 each

Summer Raffle

Raising funds for the community & local heritage

Wanborough Show Society would like to thank those who have donated prizes to the 2024 raffle.

- Bailey and Rebecca Farr - Manorbier Country Park, Tenby
- New Calley Arms
- Wanborough Show Society
- Majestic Wines
- Les Smith Transport
- The Plough
- The Harrow
- Brewers Arms
- Ramsbury Brewery
- Bath Racecourse
- Cameo Hair Salon
- Wyvern Theatre Swindon
- Wanborough Herb Nursery

Tickets can be purchased from local pubs and at the Show.

Raffle to be drawn at The New Calley Arms Sunday 18th August at 15:00

First prize donated by



Raffle supported by



Have the adventures of a lifetime with **COASTAL RESORTS** at one of our 3 Pembrokeshire, holiday parks...



Thanks to our strong culture of customer care and an emphasis on quality of service our customers enjoy our parks in Pembrokeshire year after year.

We offer a great range of holiday homes and cottages for you and your family to enjoy making those important holiday memories.

01834 871952 | info@countrypark.co.uk



Don't just take our word for it, check out our TripAdvisor to see what everyone else has to say about us, we promise not to disappoint you.



Thank you to our Summer Raffle donors



THE BREWERS ARMS
WANBOROUGH



Wanborough Herb Nursery



**THE
NEW CALLEY
ARMS**





K&H Falconry

K & H Falconry is a family run business located in Andover Hampshire. K & H Falconry are extremely dedicated in all aspects of working with their birds.

The friendly and professional team travel all over the UK entertaining the crowds. They have an amazing arrangement of birds for everyone's taste.

Watch one of the barn owls flying majestically through the air or catch an eagle owl flying from post to post. K & H Falconry have the most stunning team of falcons that will have you on the edge of your seat as they stoop into the arena at high speed!

Public Notices

Photography

On the day we usually have several photographers and videographers capturing show memories, these images and videos may be used for marketing and promotional material for future shows. If you don't want your image to be used please let the photographer know on the day. If there are any images with children in we will try to obtain the parent's permission to use these images.

If you would like to share your photos please do, you can either send them to us at info@wanboroughshow.org or share them on our Facebook page.

Vehicles (Display and General)

The show field is a busy place especially on show day. The show involves people, animals and vehicles of all types. We would like to remind people to take as much care as they would do on a busy road. In fact please take even more care!

This basic rule applies to drivers too of course. Please anticipate the unexpected and always keep to the speed limit which for all parts of the show fields, the entrances and exits is DEAD SLOW at all times!

- Please take as much care as you would do on a busy road
- Please anticipate the unexpected
- Please keep to the speed limit which is DEAD SLOW at all times!

Thank you for helping us keep a safe environment.



Children's Show

Sponsored by

See page 47 for entry form

Entry fees:

Children's Classes – **FREE**

Prizes: Certificates

richard james

Village & Country

Children's Show Rules

Judges: TBC

Rules:

1. Names to be attached or written on the REVERSE side of each entry.
2. Age only to be indicated on the side of the exhibit.
3. Only one entry per class please, which is to be entirely the own work of the named exhibitor.
4. Please adhere to schedule rules in order to avoid the disappointment of disqualification.

Awards:

Perpetual Challenge Cups:

Highest Points baby- reception

Highest Overall Points Key Stage 1

Highest Points Early Key Stage 2

Highest Points Late Keystage 2

Highest Points 11+

Highest Points Under 18's

Shield for Highest Points Overall

The Janine Brown Award for Effort and Participation in the Wanborough Show

Post entries to:

Post Entries to Beth Hoye 28 Warneage Green, Wanborough

(Clearly Marked Childrens section)

Entry form can be found on page 47.

Enquiries:

Beth Hoye 07716344996

Email entries to:

bethtreen@gmail.com



@wanbshow



@Wanborough_show



The Hedges, Wanborough



The Lynch Field, Wanborough

When *you're* ready to move,
so are we.

Whether you are thinking of selling or letting your home, contact us today for an up to date appraisal.

01793 814 542 wroughton@richardjames.uk

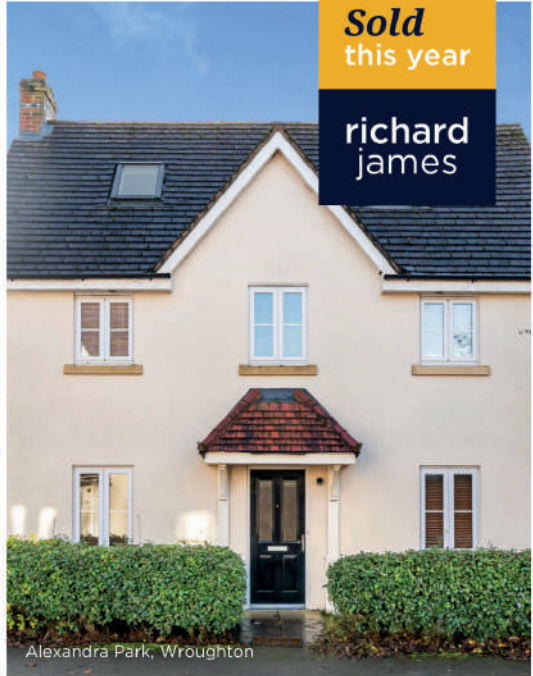

Sold
this year

**richard
james**

Alexandra Park, Wroughton



Monarch Roofing specialise in slating, traditional Cotswold stone and lead. We pride ourselves in offering a professional service on any size contract where personal attention, health and safety and quality of work are paramount.

LEADWORK • COTSWOLD STONE ROOFING • SLATING & TILING

W: www.monarchroofing.co.uk **T:** 01793 485623 **E:** office@monarchroofing.co.uk

Baby – Reception

Class

1. **Finger Print Bugs** – Make a garden scene using your hands and fingers
2. **Rainbow Collage** – Use any craft items to create a beautiful, colourful rainbow (the backing for this should be cardboard please)
3. **Animal Biscuits** – Decorate a biscuit to look like an animal – biscuits can be shop bought

Key Stage 1 – Years 1 & 2

4. **Great Fire of London Collage** – use recycled items and paper to create a scene of London Burning.
5. **3D Pirates Hook** – decorate a paper cup for the handle and create a hook out of foil and card. Make it look as pirate-like as possible.
6. **Local wildlife Fact File Poster** – Tell us about some local wildlife. What animals and plants can you see around your home?
7. **Recycled Bird House** – Use materials in your recycling box to create a bird house.
8. **Paper Plate Masks** – Use a paper plate as a base to create an imaginative mask.

Early Key Stage 2 – Years 3 & 4

9. **Labelled Poster of a Roman Soldier** – Tell us all about the things they wore, what they looked like and where they went. You could include Roman buildings or roads in your poster too!
10. **Greek Theatre Masks** – Make a mask based on Greek Theatre and the gods, use any materials to create an interesting mask.
11. **Animal Model** – Use plasticine, clay or fimo clay to create a model of your favourite animal.
12. **Robot Head** – Use a cardboard box as a base to create an exciting and interesting Robot head!
13. **Still Life Drawing** – Use everyday objects to create a beautiful picture.

Early Key Stage 2 – Years 5 & 6

14. **Recycled Material Bug Hotel** – Use recycled and gathered materials to make a cozy hotel for local bug life.
15. **Baked Treat with Handwritten Recipe** – Bake the judges something yummy-they will be tasted! But remember to submit your handwritten recipe too, feel free to decorate and illustrate your recipe too.
16. **Poem** – Hand write a poem of your own making, decorate the page with illustrations.
17. **Perspective Artwork** – Use any medium to show the judges vanishing point in a picture.
18. **Customise an Item of Clothing** – Use an old item of clothing and upcycle it!



11+

19. **Digital Drawing** – Use any computer program or app to create a picture- theme is your choice. Please print all submissions.
20. **Photo of Wanborough** – Show the judges an interesting photo of our local area. Think outside the box! Please print all submissions.
21. **Macrame** – Create a beautiful macrame piece. It does not need to be big but make it as intricate as you can.
22. **Origami Creation** – Use your paper folding skills to make an interesting origami creation.
23. **Tie Dye Fabric** – Create a beautiful tie dye item- can be clothing or a piece of fabric. Challenge yourself by trying to make a picture in your design.

Under 18

24. **Wanborough Pub picture (any medium)** – Use any style and create a picture showing one of our fantastic pubs.
25. **Handmade Jewellery** – Use anything you like to make a piece of jewellery
26. **Creative writing, short story or poem, theme “Unlikely Heroes”**
– Use the theme to create a piece of writing.



Luscious Lotmead Strawberries
Open daily 9.30 am - 5.00 pm
From May to Christmas

PYO Pick Your Own fruit and vegetables all summer long.	Farm Park Meet our friendly animals and enjoy the large outdoor play area.	Cafe & Shop Teas, coffees and light snacks served during the picking season
---	--	---

For more information:-
Visit our website www.lotmead.co.uk
Follow us on Facebook and Instagram @lotmeadfarm
or call us on 01793 790137 (24hrs)

A brand-new stunning collection

of 2, 3 and 4-bedroom homes from
a multi award-winning 5-star builder.

Redlands Grove
Wanborough | SN4 0AA



To claim **FREE** flooring throughout
on your new Bellway home, present
this leaflet to our Sales Centre.*

Bellway is proud
to support the
Wanborough Show



Register your interest

Call: 01793 351 418 Visit: bellway.co.uk

Image is indicative. *T&C's apply.

Bellway



tea & coffee

join us in the beer tent



**WANBOROUGH
SHOW SOCIETY**

"For Community & Local Heritage"
www.wanboroughshow.org



Wildlife Display

With a 'hands on' approach with a variety of animals, including Snakes, Spiders, Scorpions, Insects, Meerkats and cute and cuddles, Bryan and his qualified team provide interactive sessions throughout the day.



BACK FOR 2024

Wanborough Show Climbing Wall

This year the Wanborough Show will have a 4 man, 7 meter, climbing wall which will be staffed by **qualified guides** throughout the day.

Come try it out!

FREE!!
for all ages

(age restrictions apply)

Bellway

Sponsored by



**WANBOROUGH
SHOW SOCIETY**

"For Community & Local Heritage"
www.wanboroughshow.org



The Sweeper

You might have seen the Last Man Standing inflatable, also known as the Leg Sweeper or the Sweeper, on TV shows such as Total Wipeout. The aim of this inflatable attraction is simple - just stand on the circle, and when the leg sweeper comes towards you, jump or duck in an attempt to evade it. You need fast reflexes, accuracy and nerves of steel to defeat the Leg Sweeper!

**BACK FOR
2024**

Come try it out!

FREE!!
for all ages

(age restrictions apply)

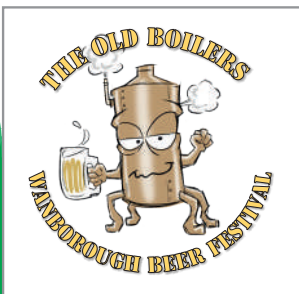

Sponsored by



"For Community & Local Heritage"
www.wanboroughshow.org

Children's Entry Form

Class No.	Exhibit Description

Name:

Age:

Address:

Contact number:

Class No.	Exhibit Description

Name:

Age:

Address:

Contact number:

Post entries to:

Beth Hoyer 28 Warneage Green, Wanborough (**Clearly Marked Childrens section**)

Enquiries: Beth Hoyer 07716344996

Alternatively entry forms can be emailed to: bethreen@gmail.com

Deadline 20:00 Thursday 15th August.

FREE ENTRY

SPREAD THE COST...

Of your pets
ROUTINE HEALTHCARE
with
PETCLUB

**Affordable
monthly payments
with discounts
included**



Wroughton • Abbey Meads • Stratton
Ridgeway Farm • Royal Wootton Bassett • Marlborough

THE WANBOROUGH COMPANION DOG SHOW

(To be held under Kennel Club Regulations)

Enter on the Day

Saturday 17th August 2024



Church Meadow Upper Wanborough SN4 0BZ

Judge: Charlotte Bell (Charakinha)

Pedigree Classes £2.50 per class

1. Any Variety Puppy 6-12months
2. Any Variety Sporting.
3. Any Variety Non - Sporting
4. Any Variety Open.

Best pedigree dog in show will now be judged.

Novelty Classes £2.50 per class

5. Best Veteran (over 7yrs.)
6. Best Crossbreed
7. Junior Handling (6-16years)
8. Prettiest Bitch
9. Best Rescue
10. Best Movement.
11. Handsome Dog.
12. Dog in Best Condition.
13. Most Appealing Eyes
14. Dog the Judge would most
Like to take home

Entries from 11.30am

Judging starts - 1:00pm

- No CC Winners - No Bitches in season - No reserve CC Winners No Junior Warrant Winners
(Pedigree classes only)

Enquiry's : KEN FRY tel.07565919872

Email : Kenneth.fry1@gmail.com



PUB FOOD AT IT'S BEST **MUDDY BOOTS AND PAWS WELCOME**

The Harrow Inn is a beautiful 17th century thatched pub that sits on the high street in Wanborough.

POOL TABLE & DART BOARD • BOARD GAMES CORNER
SHOWING ALL LIVE SPORTS • TNT SPORTS & SKY SPORTS
SEPARATE BAR AND RESTAURANT • OUTDOOR SCREENS
THREE GARDEN AREAS • BBQ • FREE PARKING
LIVE MUSIC MONTHLY • LATE NIGHT LICENSE

01793 956 486
Harrowinnswindon.co.uk

Harrow Inn, High St,
Wanborough, Swindon, SN4 0AE

Poplars Daycare
Nursery & Pre-School
QUALITY CHILDCARE



🌟 AGES 3 MONTHS - 14 years

🌟 STRONG LOCAL LINKS

🌟 OFSTED RATED 'GOOD'

🌟 EXTENSIVE OUTDOOR GROUNDS

🌟 WELL LOCATED

🌟 FLEXIBLE HOURS

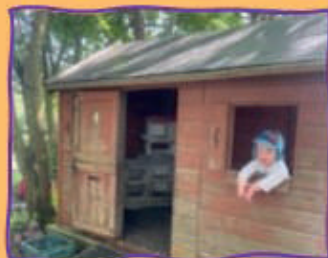

LIMITED SPACES DUE TO HIGH DEMAND

**CONTACT US TO ARRANGE A VISIT AND SECURE A SPACE FOR
YOUR LITTLE ONE...**

WATBOROUGH ROAD | SWINDON | SN4 0AA

enquiries@poplars-nursery.co.uk | 01793 790774 | www.poplars-nursery.co.uk



**Continued main sponsor of the
WANBOROUGH VILLAGE
& COUNTRY SHOW**